

2

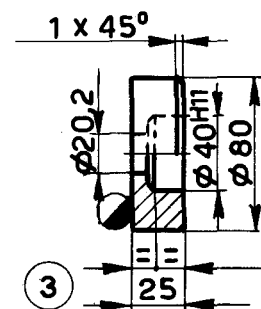

3

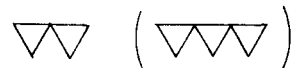

15	PUNZONE	1	∅42 x 103	C	10	Cem. e temp.
14	VITE 6 x 15 UNI 870	1		A	37	
13	MONTANTE	2	∅40 x 387	Aq	34	
12	TRAVERSA	1	73 x 73 x 273	Aq	42	
11	DADO 12 UNI 205	2		Aq	42	
10	BRACCIO	1	∅25 x 532	A	00	
9	VITE 10x20 UNI 870	1		A	37	
8	ROSETTA 10,5 UNI 1734	1		A	37	
7	ROSETTA 13 UNI 1734	2		A	37	
6	CONTRAPPESO	2	∅120 x 45	G	00	
5	VITE DI PRESSIONE	1	∅62 x 545	Aq	42	
4	BASE	1	30 x 385 x 205	A	00	
3	ANELLO DI RINFORZO	2	∅82 x 30	A	00	
2	GHIERA	1	∅82 x 25	C	10	Cem. e temp.
1	DADO 20 UNI 205	4		Aq	42	

POS.	DENOMINAZIONE	QUANT.	DIMENS. GREZZO	MATERIALE	NOTE
------	---------------	--------	----------------	-----------	------

TOLLERANZE

TEMPO CONCESSO

SCALA 1 : 4



ESERCIZIO
PROPOSTO DA